



3244



Standard Zubehör
Standard accessories



1 Satz harte einteilige Bohrbacken
1 Set of hard outside-inside solid jaws



1 Satz harte einteilige Drehbacken
1 Set of hard outside solid jaws



1 Schlüssel
1 Wrench

Ersatzteile • Spare parts 86-131

Technische Daten • Technical data 132-138

| Artikel Nr. | Typ |
|--------------|-------------|
| Code No. | Type |
| 353244210700 | 3244-125-3 |
| 353244220900 | 3244-125-4 |
| 353244230000 | 3244-160-3 |
| 353244240200 | 3244-160-4 |
| 353244250400 | 3244-160-5 |
| 353244280000 | 3244-200-4 |
| 353244290100 | 3244-200-5 |
| 353244300600 | 3244-200-6 |
| 353244330100 | 3244-250-6 |
| 353244340300 | 3244-250-8 |
| 353244360700 | 3244-315-6 |
| 353244370900 | 3244-315-8 |
| 353244380000 | 3244-315-11 |
| 353244400700 | 3244-400-8 |
| 353244410900 | 3244-400-11 |
| 353244420000 | 3244-500-8 |
| 353244430200 | 3244-500-11 |
| 353244460800 | 3244-630-11 |
| 353244470000 | 3244-630-15 |

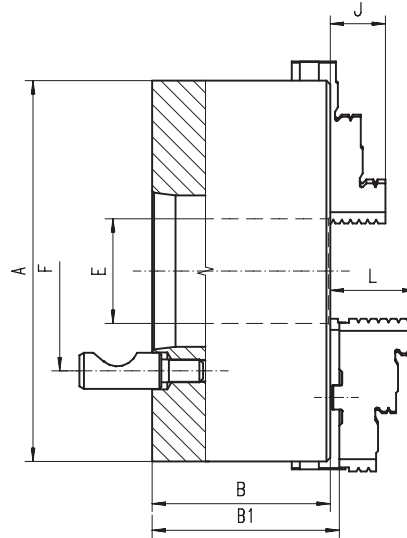

■ Geschliffene Oberflächen aller relevanten Baugruppen

■ Ground working surfaces

| A | KK 1:4 | | B | B1 | E | F | Stehbolzen | | J | L | kg |
|-----|--------|--|-------|-------|-------|-------|------------|--|----|------|-----|
| | ST 1:4 | | | | | | Stud bolts | | | | |
| 125 | 3 | | 70,0 | 74,8 | 32,0 | 70,6 | 3 | | 20 | 40,0 | 5 |
| 125 | 4 | | 70,0 | 74,8 | 32,0 | 82,6 | 3 | | 20 | 40,0 | 5 |
| 160 | 3 | | 81,5 | 86,3 | 42,0 | 70,6 | 3 | | 32 | 43,0 | 9 |
| 160 | 4 | | 81,5 | 86,3 | 42,0 | 82,6 | 3 | | 32 | 43,0 | 9 |
| 160 | 5 | | 81,5 | 86,3 | 42,0 | 104,8 | 6 | | 32 | 43,0 | 9 |
| 200 | 4 | | 91,0 | 95,8 | 51,5 | 82,6 | 3 | | 29 | 45,0 | 19 |
| 200 | 5 | | 91,0 | 95,8 | 55,0 | 104,8 | 6 | | 29 | 45,0 | 19 |
| 200 | 6 | | 91,0 | 95,8 | 55,0 | 133,4 | 6 | | 29 | 45,0 | 19 |
| 250 | 6 | | 103,5 | 107,3 | 76,0 | 133,4 | 6 | | 34 | 53,0 | 32 |
| 250 | 8 | | 103,5 | 107,3 | 76,0 | 171,4 | 6 | | 34 | 53,0 | 32 |
| 315 | 6 | | 117,7 | 122,8 | 103,0 | 133,4 | 6 | | 43 | 57,0 | 51 |
| 315 | 8 | | 117,7 | 122,8 | 103,0 | 171,4 | 6 | | 43 | 57,0 | 51 |
| 315 | 11 | | 125,0 | 130,0 | 103,0 | 235,0 | 6 | | 43 | 57,0 | 51 |
| 400 | 8 | | 128,5 | 137,3 | 136,0 | 171,4 | 6 | | 55 | 67,0 | 101 |
| 400 | 11 | | 128,5 | 137,3 | 136,0 | 235,0 | 6 | | 55 | 67,0 | 101 |
| 500 | 8 | | 146,0 | 156,8 | 136,0 | 171,4 | 6 | | 60 | 79,0 | 150 |
| 500 | 11 | | 146,0 | 156,8 | 190,0 | 235,0 | 6 | | 60 | 79,0 | 150 |
| 630 | 11 | | 165,0 | 176,3 | 190,0 | 235,0 | 6 | | 70 | 87,0 | 274 |
| 630 | 15 | | 165,0 | 176,3 | 252,0 | 330,2 | 6 | | 70 | 87,0 | 274 |

Größere Durchmesser finden Sie auf Seite 66-79! • Larger diameters available on page 66-79!



3245



Standard Zubehör
Standard accessories



1 Satz harte Aufsatzbacken
1 Set of hard top jaws



1 Satz harte Grundbacken
1 Set of hard master jaws



1 Schlüssel
1 Wrench

Ersatzteile • Spare parts 86-131

Technische Daten • Technical data 132-138

| Typ | Artikel Nr. |
|-------------|--------------|
| Type | Code No. |
| 3245-125-3 | 353245210500 |
| 3245-125-4 | 353245220700 |
| 3245-160-3 | 353245230900 |
| 3245-160-4 | 353245240000 |
| 3245-160-5 | 353245250200 |
| 3245-200-4 | 353245280800 |
| 3245-200-5 | 353245290000 |
| 3245-200-6 | 353245300400 |
| 3245-250-6 | 353245330000 |
| 3245-250-8 | 353245340100 |
| 3245-315-6 | 353245360500 |
| 3245-315-8 | 353245370700 |
| 3245-315-11 | 353245380900 |
| 3245-400-8 | 353245400500 |
| 3245-400-11 | 353245410700 |
| 3245-500-8 | 353245420900 |
| 3245-500-11 | 353245430000 |
| 3245-630-11 | 353245460600 |
| 3245-630-15 | 353245470800 |